



# WELL CASING

## SMOOTH AND SLOTTED PIPES

### TERUS SERIES

#### » TECHNICAL DATA SHEET



LIGHTWEIGHT AND EASY TO INSTALL.



MADE OF UPVC FOR GREATER DURABILITY.

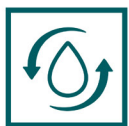

DOES NOT CONTAMINATE THE WATER.





## TERUS SERIES - CHARACTERISTICS

Smooth and slotted well casing pipes are designed for groundwater extraction systems, providing structural support to the well and ensuring efficient water flow while preventing soil intrusion.

### » APPLICATIONS



Commercial



Industrial



Agricultural



Livestock



Drinking water systems



### » ADVANTAGES

- ✓ Easier to transport, handle, and install than steel.
- ✓ Easy to connect threading, no special tools and drying time required.
- ✓ Healthier installation, as it does not contribute to bacterial growth.

### FEATURES

- uPVC construction for higher quality and resistance.
- Two options available:
  - Smooth Desing: Ideal for forming walls.
  - Slotted Design: Smooth finished with horizontal grooves that make water entry more efficient.
- Dielectric and corrosion free material.

## TECHNICAL SPECS

FOR WORKING WITH WATER TEMPERATURES UP TO 149 °F

### ACCESSORIES

COMPATIBLE WITH BOTH SERIES (80 AND 250)

#### BOTTOM CAP

Designed to force water flow through the slots and prevent solids from entering.

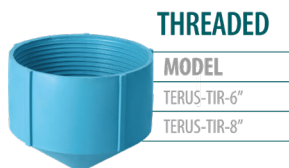

#### TEMPORARY TOP CAP

Designed to prevent external agents from entering the well.  
WARNING! This is not a support cap and must be removed when installing the pump.



#### O-RING

O-rings for sealing at the pipe connection threads.

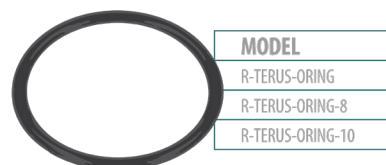



# TERUS SERIES - PERFORMANCE & DIMENSIONS

## 80 SERIES

FOR 262 ft DEPTH

GTIN-13 (E-COMMERCE CODE)	MODEL	TYPE	NOMINAL DIAMETER (in)	EXTERIOR DIAMETER (in)	MAXIMUM OUTER DIAMETER OF THE HOOD (in)	MAXIMUM WALL THICKNESS (in)	SLOT OPENING (WIDTH X LENGTH) (in)	COMPRESSIVE STRENGTH		OPEN AREA		
								(kg/cm <sup>2</sup> )	PSI	%	LPS	GPM
7503052889423	TERUS-L-80-8"	SMOOTH	0.31	8.7 ± 0.079	9.17	0.20	-	7	99.6	-	-	-
7503052889430	TERUS-R2-80-8"	SLOTTED					0.079 × 0.315	-	-	7%	1.7	26.9

## 250 SERIES

FOR 820 ft DEPTH

GTIN-13 (E-COMMERCE CODE)	MODEL	TYPE	NOMINAL DIAMETER (in)	EXTERIOR DIAMETER (in)	MAXIMUM OUTER DIAMETER OF THE HOOD (in)	MAXIMUM WALL THICKNESS (in)	SLOT OPENING (WIDTH X LENGTH) (in)	COMPRESSIVE STRENGTH		OPEN AREA			
								(kg/cm²)	PSI	%	LPS	GPM	
7503052889447	TERUS-L-250-6"	SMOOTH	0.24	6.3 ± 0.079	6.97	0.24	-	18	256.0	-	-	-	
7503052889454	TERUS-R2-250-6"	SLOTTED					0.079 × 0.256	-	-	10%	2	31.7	
7503052889461	TERUS-L-250-8"	SMOOTH	0.31	8.7 ± 0.079	9.45	0.35	-	18	256.0	-	-	-	
7503052889478	TERUS-R2-250-8"	SLOTTED					0.079 × 0.315	-	-	10%	2.1	33.3	
7503052889485	TERUS-L-250-10"	SMOOTH	0.39	10.6 ± 0.079	11.50		-	18	256.0	-	-	-	
7503052889492	TERUS-R2-250-10"	SI OTTOD					0.079 × 0.354	-	-	10%	2.5	39.6	

## 80 SERIES

MODEL	DIMENSIONS (in)									WEIGHT (Lb)
	A	B	C	D	E	F	G	H	I	
TERUS-L-80-8"	114.17	9.17	3.39	8.66	2.91	8.27	8.86	0.16	0.20	47.8
TERUS-R2-80-8"										46.3

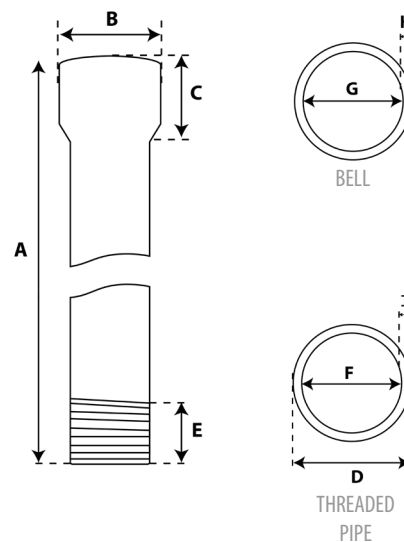

## 250 SERIES

MODEL	DIMENSIONS (in)									WEIGHT (Lb)
	A	B	C	D	E	F	G	H	I	
TERUS-L-250-6"	114.17	6.97	2.76	6.30	2.48	5.83	6.57	0.20	0.24	34.4
TERUS-R2-250-6"										33.1
TERUS-L-250-8"		9.45	3.39	8.74	2.91	8.03	8.98	0.24	0.35	66.8
TERUS-R2-250-8"										65.0
TERUS-L-250-10"		11.50	4.02	10.55	3.54	9.84	11.02	0.00	0.00	102.1
TERUS-R2-250-10"										100.3

## LOWER AND UPPER COVERS

MODEL	DIMENSIONS (in)			WEIGHT (Lb)
	A	B	C	
TERUS-TIR-6"	7.01	6.54	5.12	0.7
TERUS-TIR-8"	9.45	8.90	5.71	1.5
TERUS-TIP-8"				
TERUS-TS-8"	8.78	8.31	6.30	2.2
TERUS-TSP-8"	9.57	9.02	6.77	3.7

